

PLAN ARMARE PLATFORMA BETONATA CU 2 RANDURI DE PLASE SUDATE SPPB Ø8/100/100

18.00

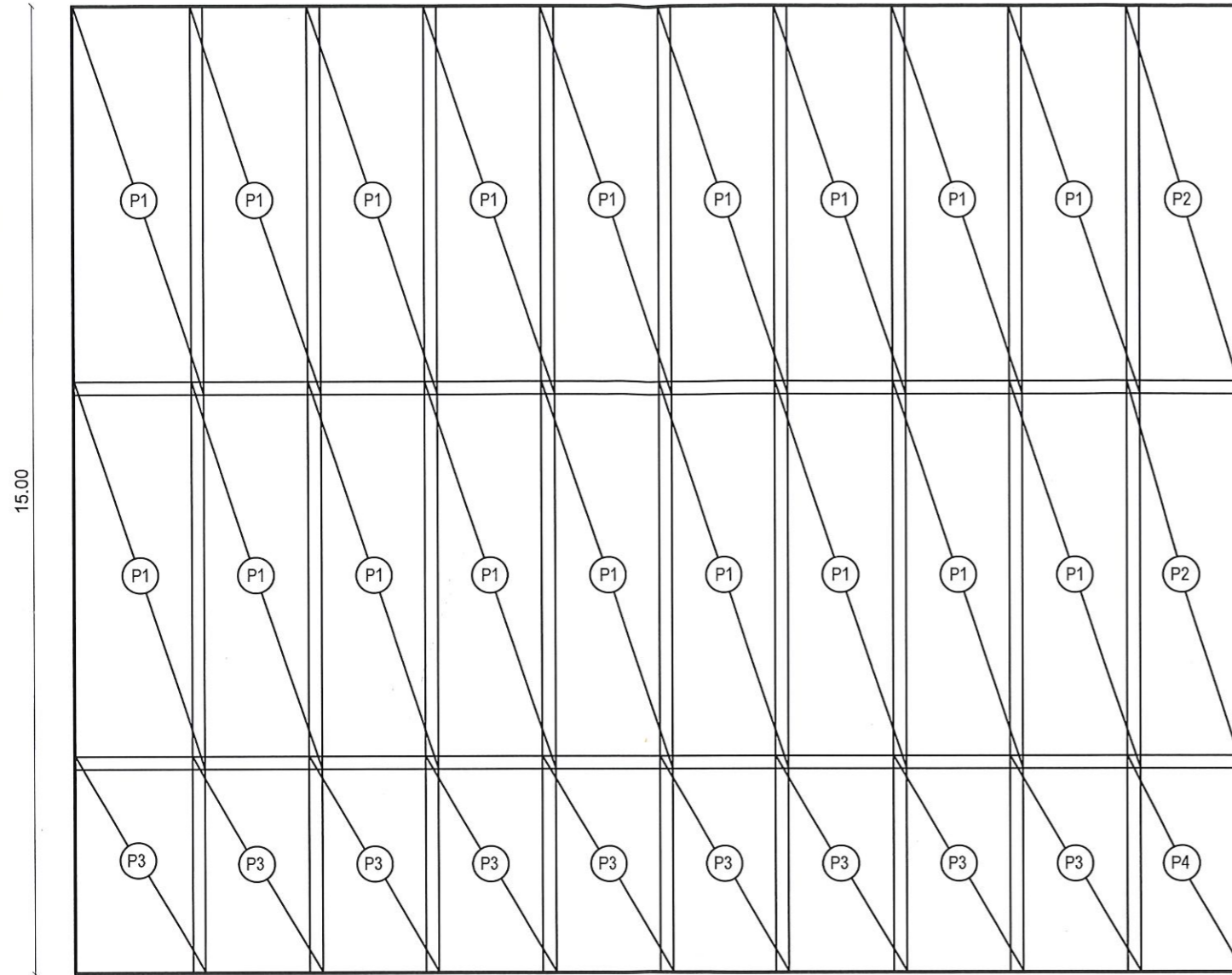

15.00

PLAN TAIERE ROSTURI PLATFORMA BETONATA

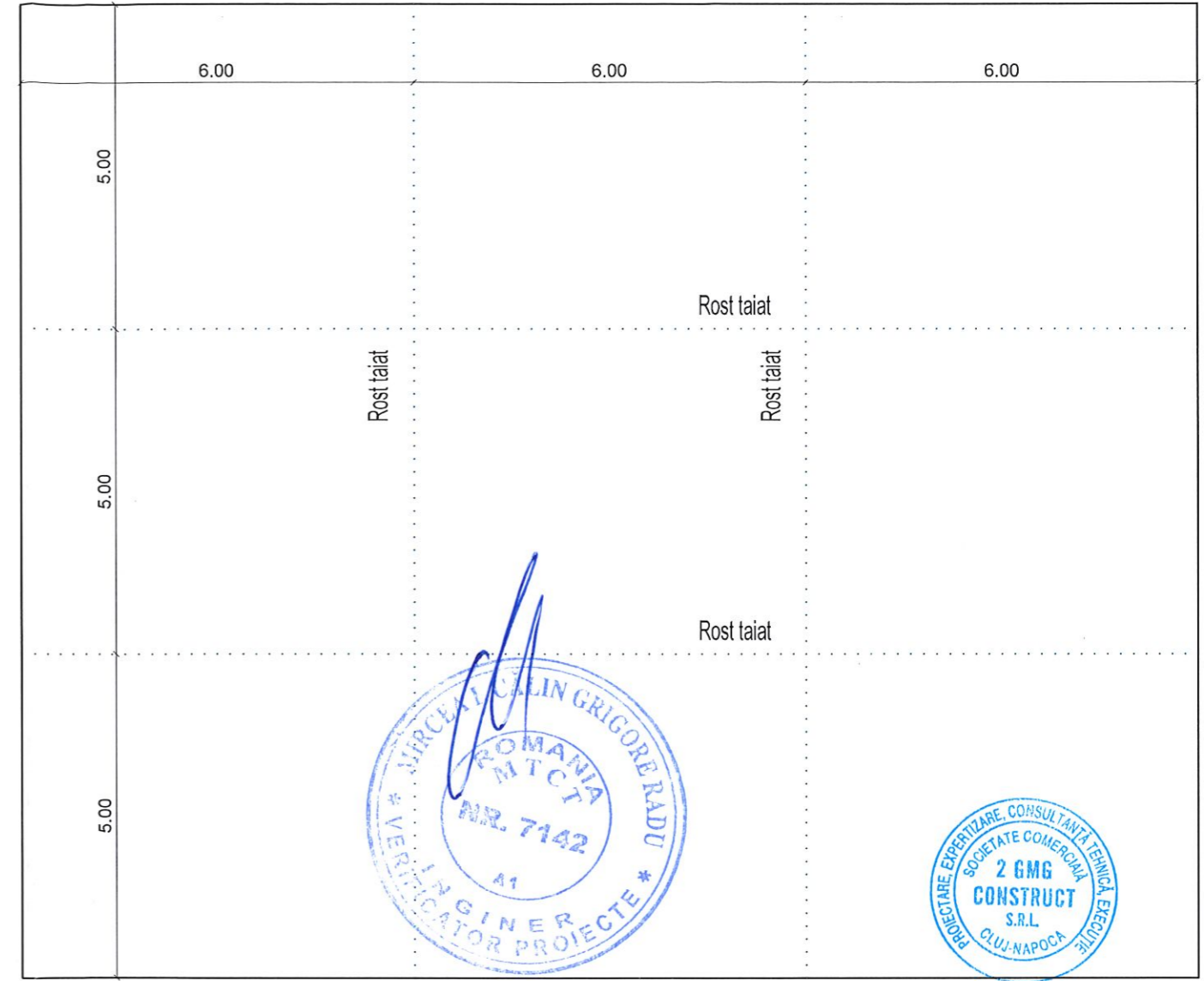

DETALIU ARMARE PLATFORMA BETONATA

Platforma din beton slab armata cu 2 randuri de plase sudate Ø8/100/100, grosime 20 cm
Balast compactat 50 cm
Geotextil
Teren natural

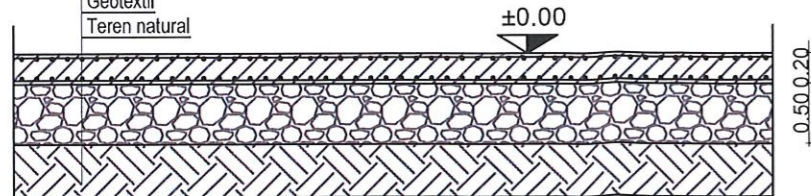

Detaliu Rost taiat:

Umplerea rosturilor taiate (provizorie):

Umplerea rosturilor (final dupa 80 zile):

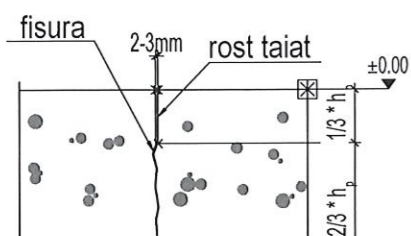

Adancime de taiere 1/3 x h

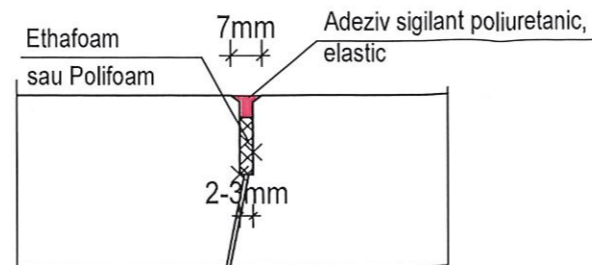
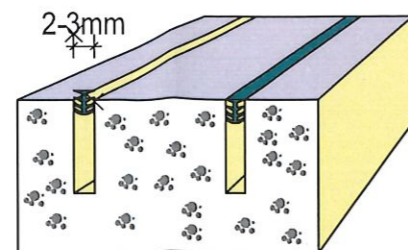

Nota! Platforma va servi ca suport pentru containerele de tip modular.

Beton armat: C30/37
-clasa de expunere: XC2/XA1
Strat acoperire cu beton: 25 mm
Otel utilizat: SPPB Ø8/100/100

NOTA:
Se vor taia rosturi in ochiuri de 6.00x5.00 m.

Legenda:
..... ROST DE TAIERE

NECESAR DE MATERIAL
Lungime rosturi taiate
(Adancime taiere ~5cm): 66,00 ml



ACEST DESEN ESTE PROPRIETATEA INTELECTUALA A SC 2 GMG CONSTRUCT SRL				
REPRODUCEREA POATE FI FACUTA NUMAI CU ACORDUL SI IN CONDITIILE STABILITE DE SC 2 GMG CONSTRUCT SRL				
Verificator/Expert	Nume	Semnatura	Cerinta	Referat nr./ Expertiza Nr./ Data
PROIECTANT GENERAL:	S.C. 2 GMG CONSTRUCT S.R.L. <small>CLUJ-NAPOCA, CAL. DIMA 29/31, RD. CLUJ J1229/2007, CUI RO20113550 Tel. 0749198768, Email: inform@ibrog@yahoo.ro</small>			Titlu proiect:
PROIECTANT DE SPECIALITATE: REZISTENTA	S.C. 2 GMG CONSTRUCT S.R.L. <small>CLUJ-NAPOCA, CAL. DIMA 29/31, RD. CLUJ J1229/2007, CUI RO20113550 Tel. 0749198768, Email: inform@ibrog@yahoo.ro</small>			Amplasament: com. Ipotesli si Salcea, jud. Suceava
	NUME	SEMNTATURA	Scara:	Beneficiar:
SEF PROIECT	ing. Ghindea M.		1:100	MUNICIPIUL SUCEAVA
PROIECTAT	ing. Ghindea M.		Data:	Faza:
DESENAT	ing. Ghindea M.		2023	S.F.
				DETALII REALIZARE PLATFORMA BETONATA
				Plansa: R.02