

P2073 - PL 15x170x363
Qty.:3 / Material: S355
Sc.:1:10

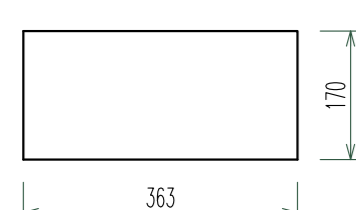

P2083 - PL 12x110x248
Qty.:2 / Material: S355
Sc.:1:10

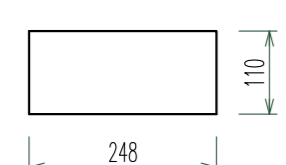

P2091 - PL 8x100x155
Qty.:2 / Material: S355
Sc.:1:10

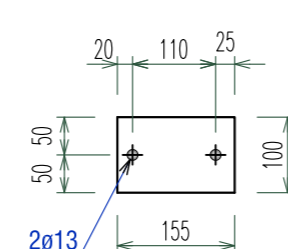

P2100 - PL 10x192x202
Qty.:1 / Material: S355
Sc.:1:10

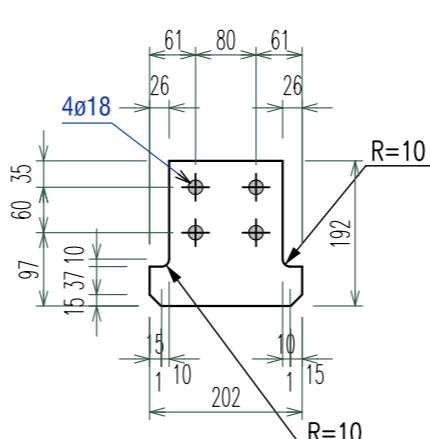

P2107 - PL 15x270x363
Qty.:1 / Material: S355
Sc.:1:10

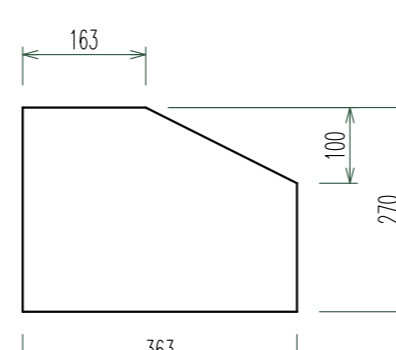

P2114 - PL 8x127x193
Qty.:1 / Material: S355
Sc.:1:10

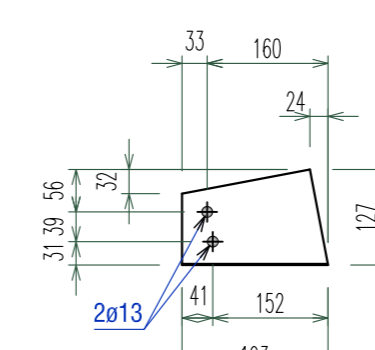

P2074 - PL 15x311x452
Qty.:3 / Material: S355
Sc.:1:10

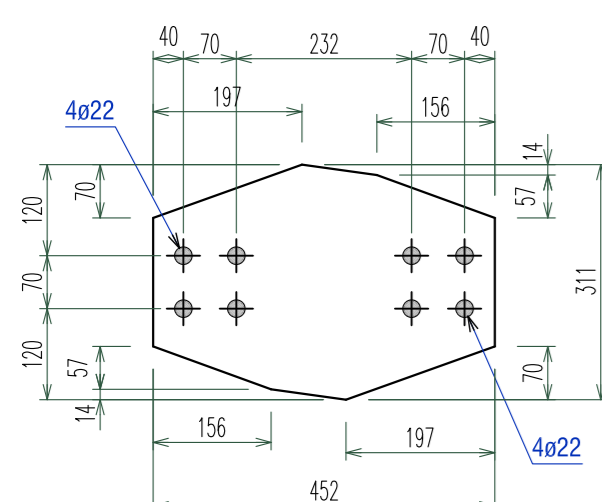

P2087 - PL 15x250x380
Qty.:2 / Material: S355
Sc.:1:10

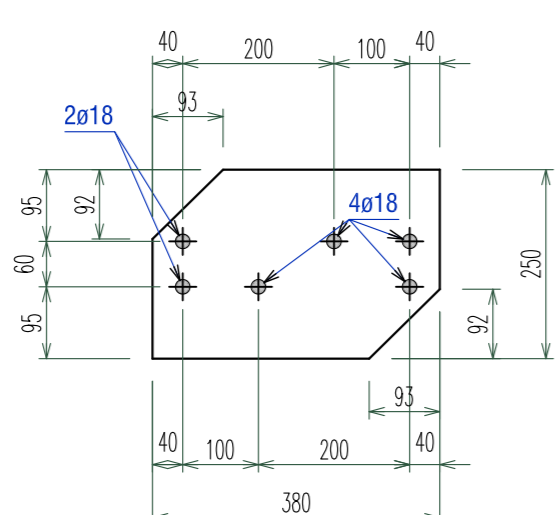

P2093 - PL 10x115x220
Qty.:1 / Material: S355
Sc.:1:10

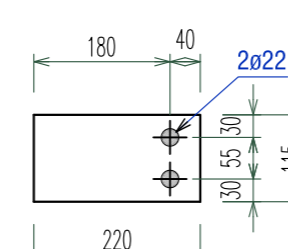

P2102 - PL 12x100x222
Qty.:1 / Material: S355
Sc.:1:10

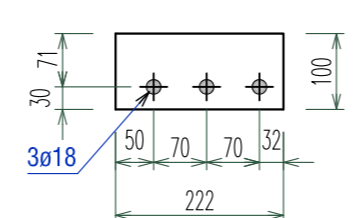

P2111 - PL 8x122x164
Qty.:1 / Material: S355
Sc.:1:10

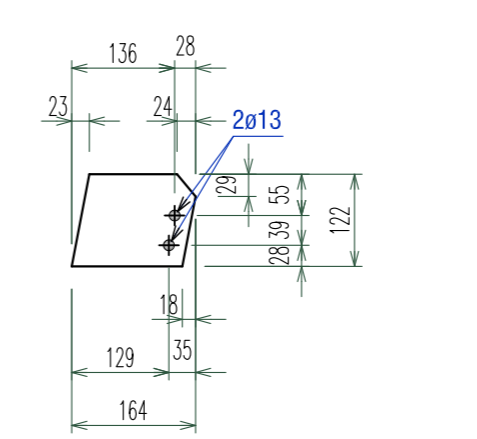

P2075 - PL 10x110x230
Qty.:2 / Material: S355
Sc.:1:10

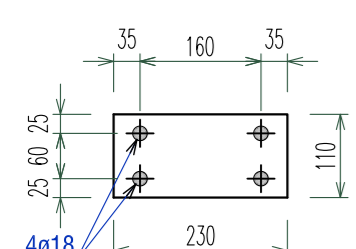

P2080 - PL 10x206x231
Qty.:2 / Material: S355
Sc.:1:10

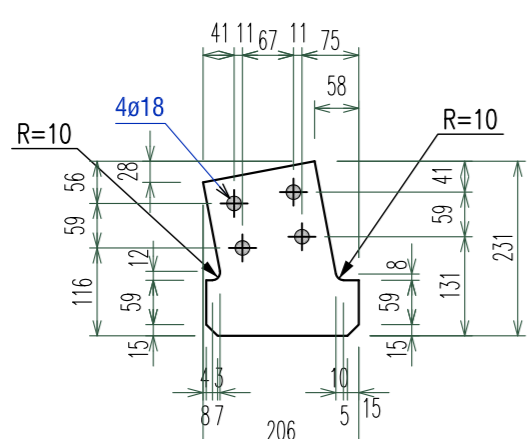

P2090 - PL 6x200x232
Qty.:2 / Material: S355
Sc.:1:10

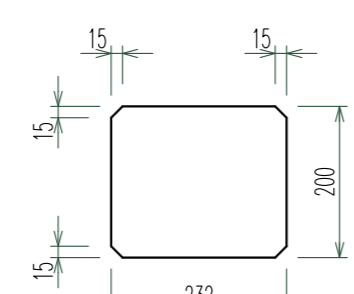

P2095 - PL 10x130x253
Qty.:1 / Material: S355
Sc.:1:10

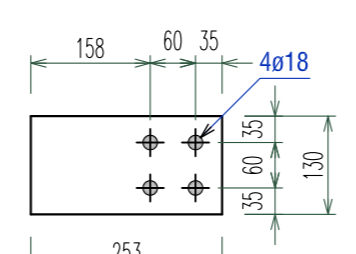

P2105 - PL 15x155x290
Qty.:1 / Material: S355
Sc.:1:10

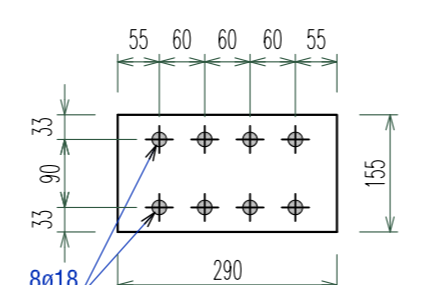

P2112 - PL 8x122x174
Qty.:1 / Material: S355
Sc.:1:10

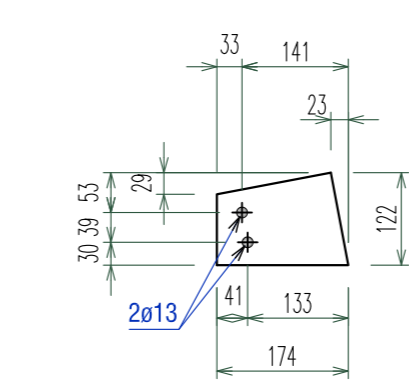

P2076 - PL 10x152x232
Qty.:2 / Material: S355
Sc.:1:10

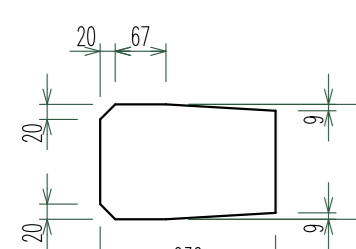

P2082 - PL 12x110x219
Qty.:2 / Material: S355
Sc.:1:10

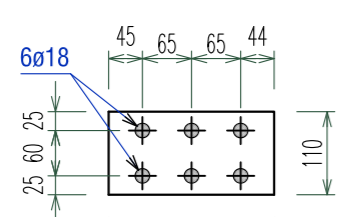

P2088 - PL 15x264x363
Qty.:2 / Material: S355
Sc.:1:10

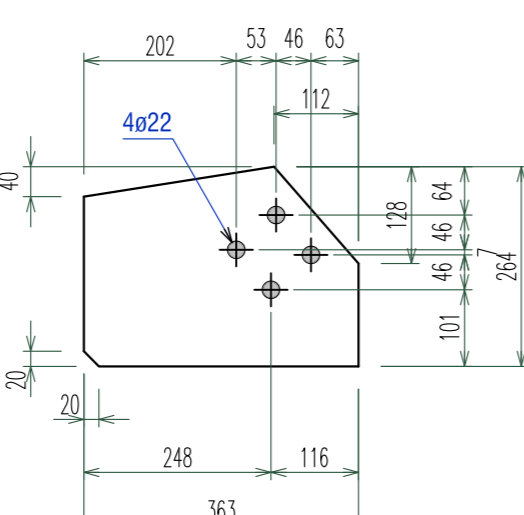

P2096 - PL 10x130x261
Qty.:1 / Material: S355
Sc.:1:10

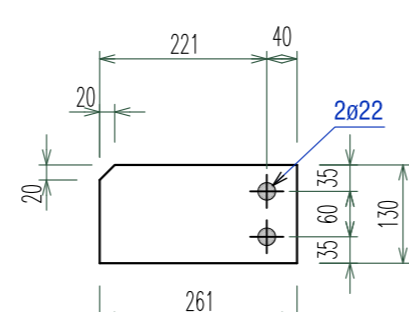

P2106 - PL 15x250x380
Qty.:1 / Material: S355
Sc.:1:10

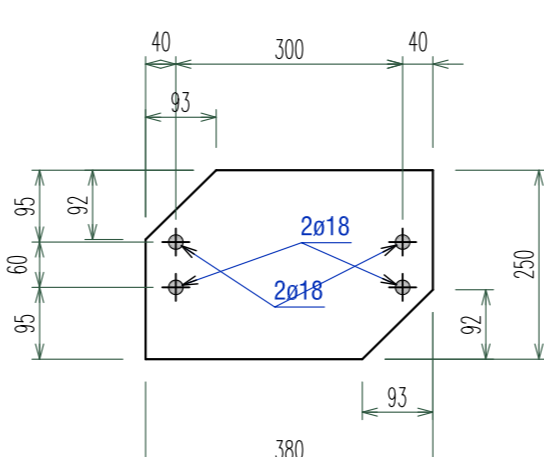

P2113 - PL 8x123x177
Qty.:1 / Material: S355
Sc.:1:10

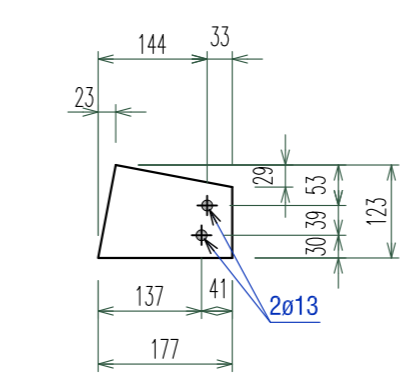

P2077 - PL 10x177x200
Qty.:2 / Material: S355
Sc.:1:10

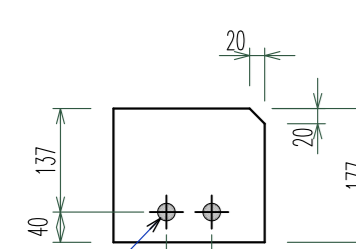

P2084 - PL 12x210x278
Qty.:2 / Material: S355
Sc.:1:10

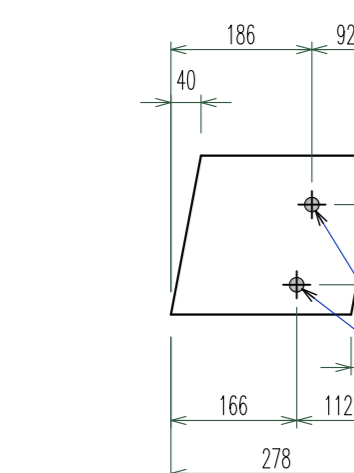

P2092 - PL 8x52x202
Qty.:2 / Material: S355
Sc.:1:10

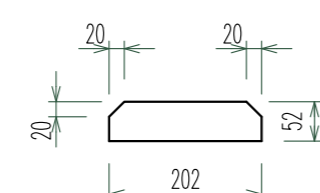

P2101 - PL 10x87x152
Qty.:1 / Material: S355
Sc.:1:10

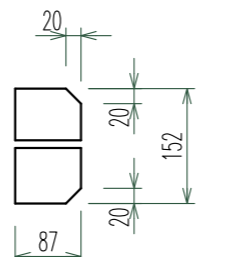

P2108 - PL 15x346x487
Qty.:1 / Material: S355
Sc.:1:10

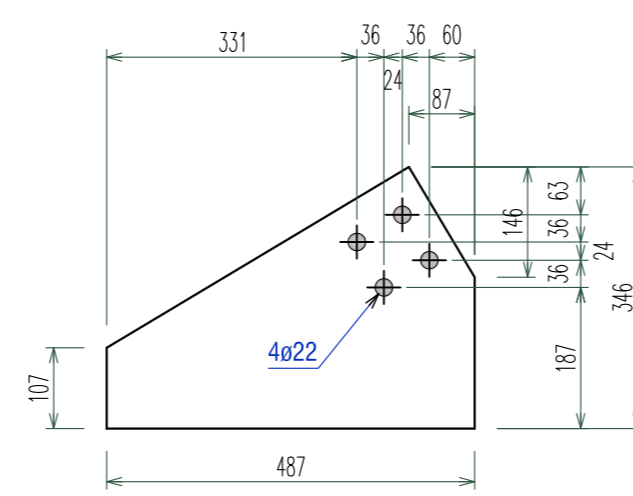

P2115 - PL 8x232x250
Qty.:1 / Material: S355
Sc.:1:10

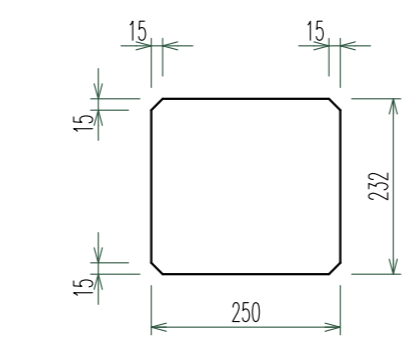

P2078 - PL 10x177x254
Qty.:2 / Material: S355
Sc.:1:10

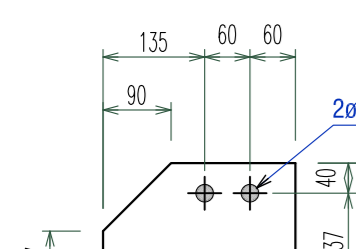

P2086 - PL 15x249x531
Qty.:2 / Material: S355
Sc.:1:10

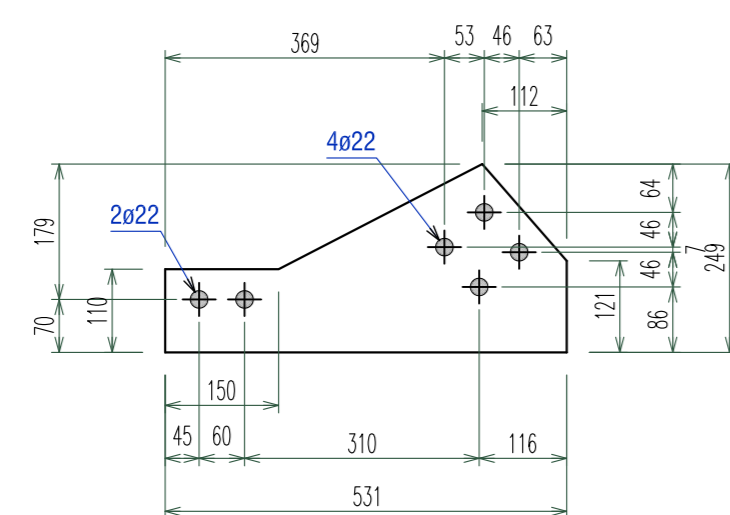

P2094 - PL 10x130x226
Qty.:1 / Material: S355
Sc.:1:10

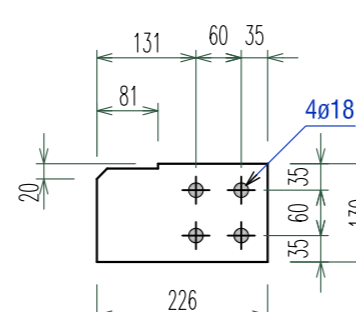

P2103 - PL 12x176x247
Qty.:1 / Material: S355
Sc.:1:10

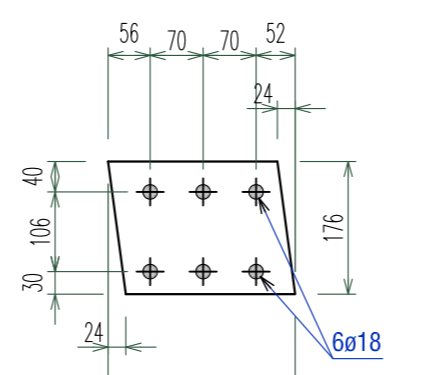

P2109 - PL 15x349x555
Qty.:1 / Material: S355
Sc.:1:10

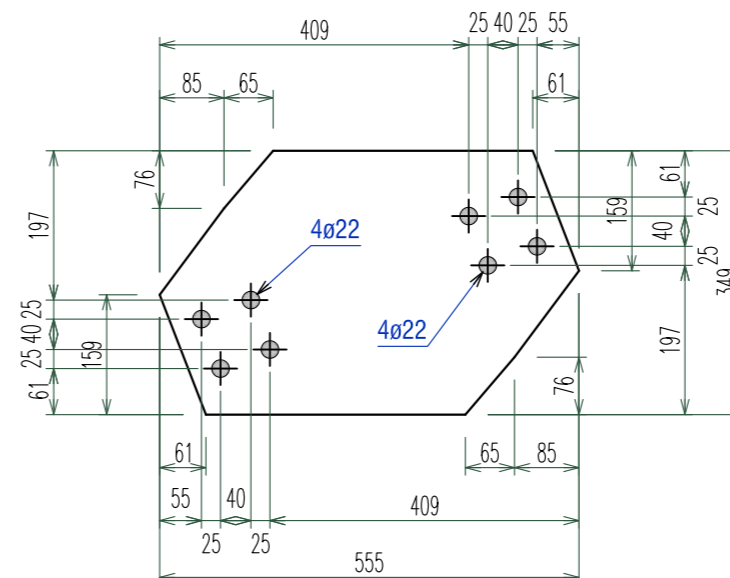

P2079 - PL 10x204x224
Qty.:2 / Material: S355
Sc.:1:10

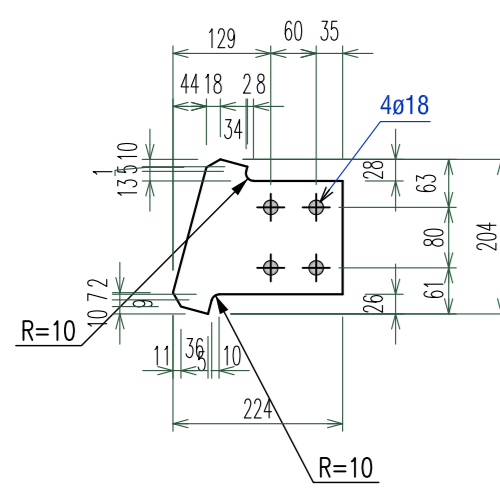

P2085 - PL 15x135x270
Qty.:2 / Material: S355
Sc.:1:10

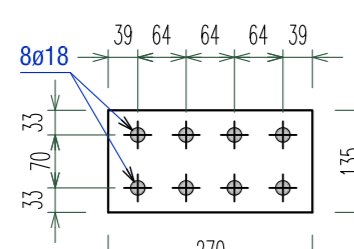

P2098 - PL 10x132x230
Qty.:1 / Material: S355
Sc.:1:10

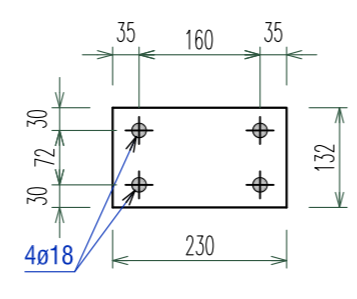

P2104 - PL 12x181x335
Qty.:1 / Material: S355
Sc.:1:10

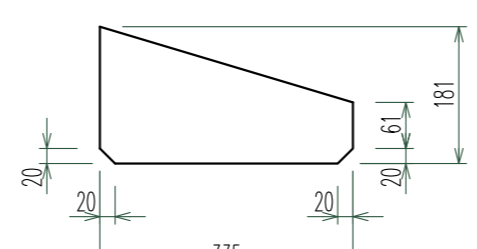

P2110 - PL 6x191x206
Qty.:1 / Material: S355
Sc.:1:10

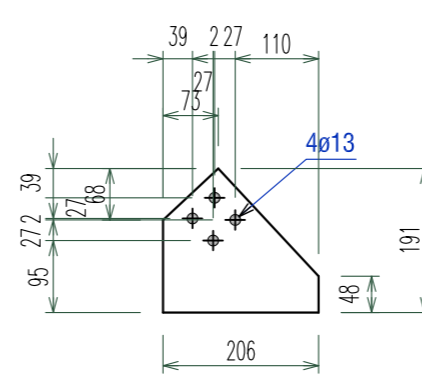

P2081 - PL 12x110x210
Qty.:2 / Material: S355
Sc.:1:10

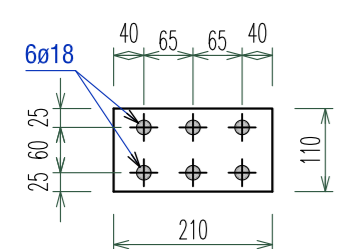

Mark	Quantity	In Assembly
P2073	3	ST.10
P2074	2	CVV.13
P2075	1	CVV.15
P2076	2	GR.26
P2077	1	ST.41
P2078	1	ST.28
P2079	1	ST.25
P2080	1	ST.30
P2081	2	GR.17
P2082	2	GR.18
P2083	2	GR.18
P2084	1	GR.7
P2085	1	GR.7
P2086	1	GR.10
P2087	1	GR.19
P2088	1	GR.23
P2089	1	GR.25
P2090	1	ST.41
P2091	1	ST.18
P2092	1	ST.23
P2093	1	ST.28
P2094	1	ST.18
P2095	1	ST.23
P2096	1	ST.28
P2097	1	ST.18
P2098	1	ST.23
P2099	1	ST.28
P2100	1	GR.18
P2101	1	ST.41
P2102	1	ST.47
P2103	1	GR.24
P2104	1	ST.47
P2105	1	GR.25
P2106	1	ST.31
P2107	1	ST.47
P2108	1	ST.38
P2109	1	CVV.16
P2110	1	PA.54
P2111	1	PA.74
P2112	1	GR.24
P2113	1	GR.19
P2114	1	ST.47
P2115	1	ST.41

Mark	Quantity	Description	Length	Grade	Part weight	Total weight
P2073	3	PL 15x170x363	363	S355	7.3	21.8
P2074	2	PL 15x311x452	452	S355	13.2	39.6
P2075	1	PL 10x110x230	230	S355	2	4.4
P2076	2	PL 10x152x232	232	S355	2.6	5.3
P2077	1	PL 10x177x200	200	S355	2.8	5.5
P2078	2	PL 10x177x254	254	S355	3.2	6.4
P2079	2	PL 10x204x224	224	S355	2.9	5.8
P2080	2	PL 10x206x231	231	S355	3.2	6.3
P2081	2	PL 12x110x210	210	S355	2.2	4.4
P2082	2	PL 12x110x219	219	S355	2.3	4.5
P2083	2	PL 12x110x248	248	S355	2.6	5.1
P2084	2	PL 12x210x278	278	S355	4.7	9.4
P2085	2	PL 15x135x270	270	S355	4.3	8.6
P2086	2	PL 15x249x531	531	S355	11.3	22.6
P2087	2	PL 15x250x380	380	S355	10	20.4
P2088	2	PL 15x264x363	363	S355	9.8	19.7
P2089	2	PL 15x351x369	369	S355	13.6	27.1
P2090	2	PL 6x200x232	232	S355	2.2	4.3
P2091	2	PL 8x100x155	155	S355	1	1.9
P2092	2	PL 8x52x202	202	S355	0.6	1.3
P2093	1	PL 10x115x220	220	S355	2	2
P2094	1	PL 10x130x226	226	S355	2.3	2.3
P2095	1	PL 10x130x253	253	S355	2.6	2.6
P2096	1	PL 10x130x261	261	S355	2.6	2.6
P2097	1	PL 10x132x177	177	S355	1.8	1.8
P2098	1	PL 10x132x230	230	S355	2.4	2.4
P2099	1	PL 10x145x150	150	S355	1.7	1.7
P2100	1	PL 10x192x202	202	S355	2.7	2.7
P2101	1	PL 10x87x152	152	S355	1	1
P2102	1	PL 12x100x222	222	S355	2.1	2.1
P2103	1	PL 12x176x247	247	S355	3.7	3.7
P2104	1	PL 12x181x335	335	S355	4.1	4.1
P2105	1	PL 15x155x290	290	S355	5.3	5.3
P2106	1	PL 15x250x380	380	S355	10.2	10.2
P2107	1	PL 15x270x363	363	S355	10.4	10.4
P2108	1	PL 15x346x487	487	S355	13.5	13.5
P2109	1	PL 15x349x555	555	S355	18.4	18.4
P2110	1	PL 6x191x206	206	S355	1.3	1.3
P2111	1	PL 8x122x164	164	S355	1.1	1.1
P2112	1	PL 8x122x174	174	S355	1.1	1.1
P2113	1	PL 8x123x177	177	S355	1.1	1.1
P2114	1	PL 8x127x193	193	S355	1.3	1.3
P2115	1	PL 8x232x250	250	S355	3.6	3.6
65					Combined Total	320.2

NOTE CONFECTIE METALICA

- Condițiile tehnice de calitate vor respecta prevederile SR EN 1090-2: Executarea structurilor din oțel și aluminiu. Partea 2: Cerințe tehnice pentru structuri de oțel. Clasa de execuție a structurilor metalice este EXC 3
- Toleranțele la execuția în uzină a elementelor cu dimensiuni:
 - < 5,00m - 0,50mm / > 5,00m - 1,00mm
- Nivelul de acceptare pentru îmbinările sudate este "B" pentru cordoanele de sudură în adâncime și "C" pentru cordoanele de sudură în relief, în conformitate cu normativul C150-1999.
- Dacă nu se specifică altfel în desen sudurile se vor executa în relief cu grosimea egală cu 0,7t_{max}, unde t_{max} reprezintă grosimea minimă a elementelor care se sudă, pe toată lungimea de contact a acestora.
- Plăcile de capăt se vor sudă cu sudură în adâncime în K cu patură de sudură în V și rezidua rădăcinii.
- În atelierul de montaj se va face obligatoriu presarea tronsoanelor și se vor verifica dimensiunile ansamblului. Orice neconformitate de date sau de calitate va fi semnalată proiectantului. Construcțiile este direct raspunzător pentru asigurarea stabilității structurilor pe durata montajului acestora.
- Toate cotele sunt date în mm, cu excepția cotelor de nivel care sunt date m.
- Protecția anticorozivă a structurilor metalice: cf. GP 121/1-2013. Clasa de coroziune: C2 - slabă
Pentru structuri deschise amplasate la exterior expuse precipitațiilor se recomandă zincarea termică. În cazul structurilor zincate termic, în elementele închise se prevăd obligatoriu găuri de zincare.

MATERIALE CONFECTIE METALICA / STEEL STRUCTURE MATERIALS:

ELEMENT:	MATERIAL:	STANDARD:
OTEL LAMINAT STRUCTURA METALICA	S355J0 (H) / S235JR (H) - laminat	SR EN 10025, SR EN 10210, SR EN 10219
Structural steel	S355J0 - profile cu pereți suduri	SR EN 10162
ORGANE DE ASAMBLARE	GR.10.9 - partial Nitrate	SREN 14399
Bolting assemblies	L.10.9 - compact filare	EN ISO 4017
SURURILE DE ANCORAJ	S355JR/8.8 - carcasa suruburi	
Anchor bolts	gr.8.8 - ancoraj chimic	

MOMENTE DE STRAGERE PENTRU ORGANELE DE ASAMBLARE

Nr.	Diametru nominal	Grupa	MOMENT FINAL DE STRANGERE (Nm)	50%-70% DIN MOMENTUL FINAL DE STRANGERE (Nm)	Nr.	Diametru nominal	Grupa	MOMENT FINAL DE STRANGERE (Nm)	50%-70% DIN MOMENTUL FINAL DE STRANGERE (Nm)
1	M12	10.9	100	50-70	5	M24	10.9	800	400-560
2	M16	10.9	250	125-175	6	M27	10.9	1250	625-875
3	M20	10.9	450	225-315	7	M30	10.9	1650	825-1155
4	M22	10.9	450	225-315					

LEGENDA DENUMIRI PROFILE SI TABLE / PROFILES & PLATES NAMES:

RHS, Tv - Tava piratata/rectangulara (Square/rectangular hollow section)
 RD, Tv.G, RHSO - Tava rotunda (Circular hollow section)
 FL - Platbanda (Flat bar)
 L, LNP - Cornier (Angle profile)
 U, LNP, UPE - Profil U (Channel profile)
 I, PE, PNI - Profil I (profile)
 HEA, HEB - Profil I cu tablă late (Wide flanges I profile)
 C, Z - Profil C sau Z format la rece (Cold-rolled C or Z profile)
 TB, PL - Tabla groasa (Thick plate)
 RD - Bara din oțel rotund (Round bar)

PROIECTANTII GENERALI PR® EXPERT DESIGN Strada: ... Telefon: ... E-mail: ... Web: ...		PROIECT EXTINDEREA PE VERTICALA (MANSARDARE) SI DOTARE A CLADIRII SCOLII GIMNAZIALE MIRON COSTIN SI ADAPTAREA SISTEMULUI DE EDUCATIE LA EVOLUTIA TEHNologica. AMPLASAMENT Beneficiar PRIMARIA MUNICIPIULUI SUCEAVA Strada: ... Nr. ... Jud. Suceava	
PROIECTANT STRUCTURA ALCO INGINIERIE Strada: ... Telefon: ... E-mail: ... Web: ...		BENEFICIAR PRIMARIA MUNICIPIULUI SUCEAVA Strada: ... Nr. ... Jud. Suceava	
RESPONSABILITATI SEF PROIECT PROIECTAT DESENAT VERIFICAT Ing. Ion Gligor		BENEFICIAR Ing. M. Urovan Ing. Coca Alexandru Ing. Coca Alexandru Ing. Ion Gligor	
SCALA DE REDACTARE 1:10		DATA INTOCMIRII 10/2023	
NR. PLANSA RM-208		DATA	